

**ZONING MAPS
OF
KANE COUNTY, ILLINOIS**
MAP NO. BL-20
MAP SCALE
1" = 200' FEET

Kane County, Illinois
Building and Zoning Division

Mark D. VanKerkhoff, AIA
Zoning Enforcing Officer

Kane County
Government Center
719 S. Batavia Ave., Bldg. A
Geneva, IL 60134

Phone: 630-232-3492

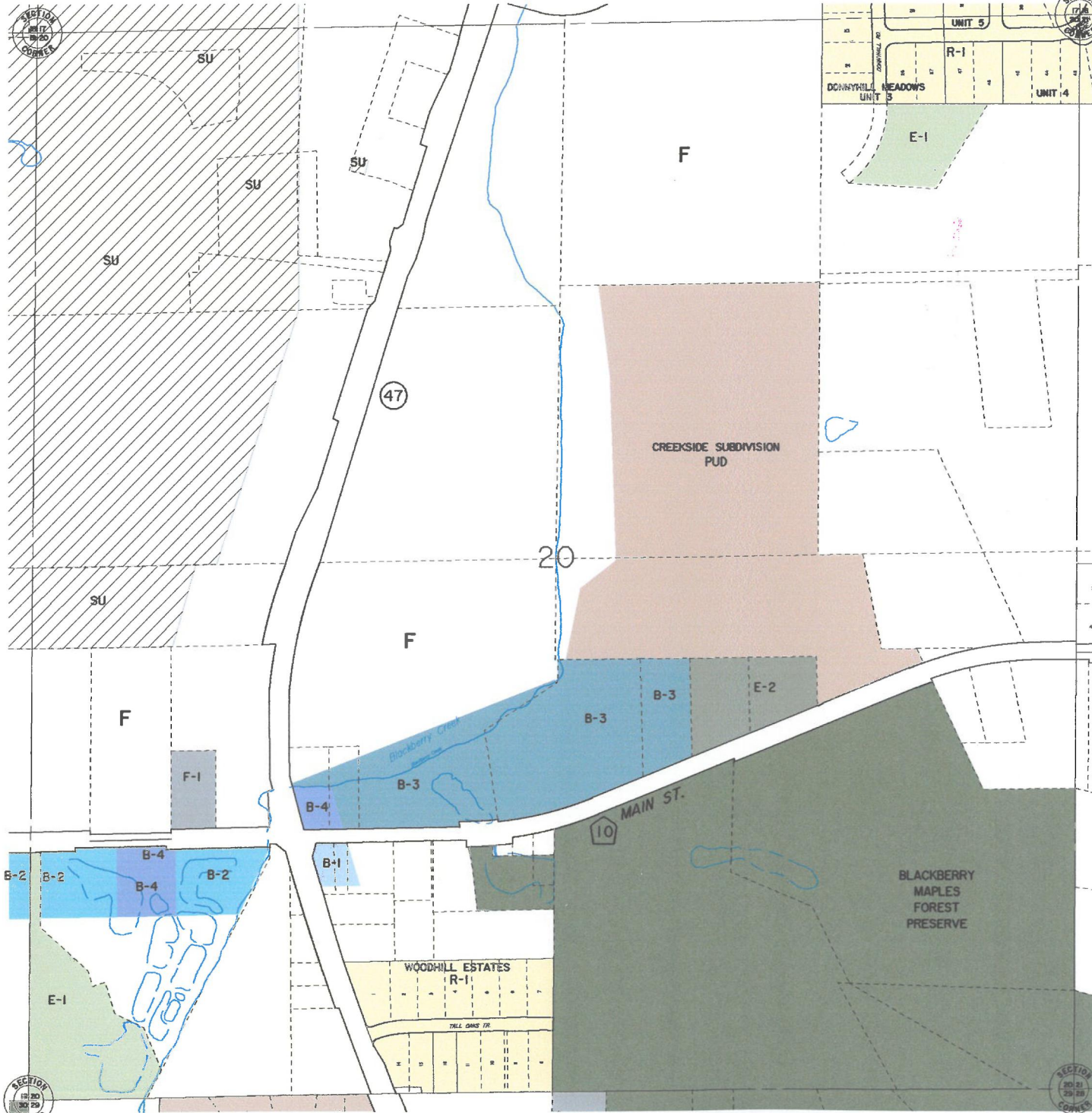

SECTION 20
BLACKBERRY TOWNSHIP

Adopted	Repealed
5/7/91	
7/15/98	

Based on Ordinance No. 12, 2008 (11/11/08), 1500
Some data derived as of December 15, 2010.
Forest Preserve property as of December 15, 2010.



BL-20 ZONING

ZONING LEGEND

FARMING DISTRICT	F	
	F-1	
	F-2	
ESTATE FAMILY	E-1	
	E-2	
	E-2A	
	E-3	
	R-1	
SINGLE FAMILY	R-2	
	R-3	
	R-4	
	R-5	
DUPLX	R-6	
	R-7	
MULT.	R-8	
	R-9	
BUSINESS DISTRICT	RB	
	B-1	
	B-2	
	B-3	
	B-4	
	B-5	
	B-6	
SPECIAL INDUSTRIAL DISTRICT	LI	
	I	
	PUD	
AIRPORT DISTRICT	A-1	
	A-2	
OTHER	SU	
	Incorporated Forest Preserve	