

**ZONING MAPS
OF
KANE COUNTY, ILLINOIS**
MAP NO. RU-27
MAP SCALE
0 100 200 300 400 500
FEET

Kane County, Illinois
Building and Zoning Division
Mark D. VanKerkhoff, AIA
Zoning Enforcing Officer

Kane County
Government Center
719 S. Batavia Ave., Bldg. A
Geneva, IL 60134

Phone: 630-232-3492

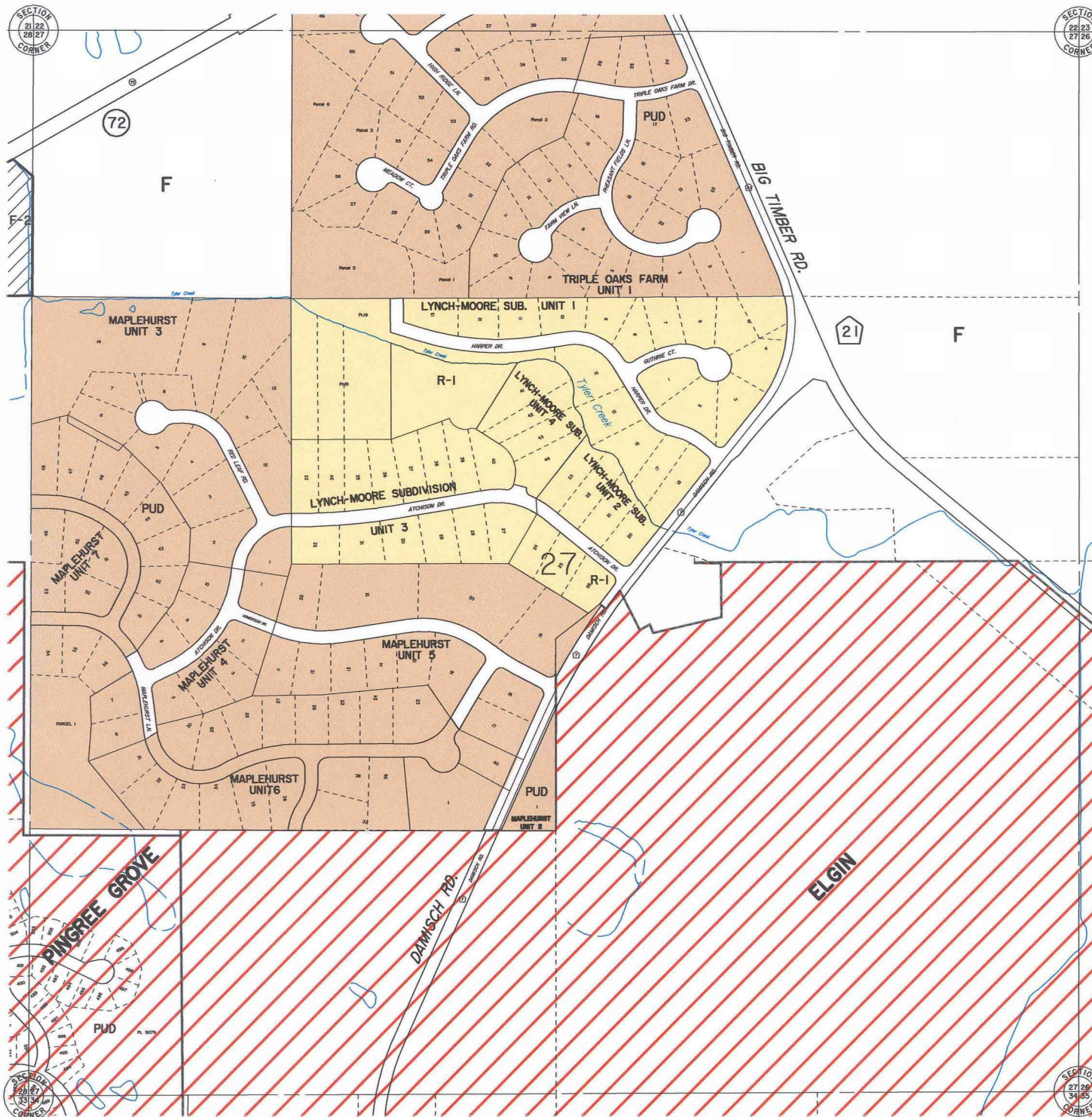

ZONING LEGEND		
F	FARMING DISTRICT	[White Box]
F-1		[Light Blue Box]
F-2		[Diagonal Lines Box]
E-1	ESTATE FAMILY	[Light Green Box]
E-2		[Medium Green Box]
E-2A		[Dark Green Box]
E-3		[Light Yellow Box]
R-1	SINGLE FAMILY	[Yellow Box]
R-2		[Orange Box]
R-3		[Light Orange Box]
R-4		[Red-Orange Box]
R-5	DUPLICATE	[Red Box]
R-6		[Red Box]
R-7		[Red Box]
R-8		[Red Box]
R-9	MULT.	[Brown Box]
RB		[Light Blue Box]
B-1	BUSINESS DISTRICT	[Blue Box]
B-2		[Light Blue Box]
B-3		[Medium Blue Box]
B-4		[Dark Blue Box]
B-5		[Blue-Gray Box]
B-6		[Dark Blue-Gray Box]
LI	SPECIAL INDUSTRIAL DISTRICT	[Purple Box]
I		[Light Purple Box]
PUD		[Light Brown Box]
A-1	AIRPORT DISTRICT	[Light Brown Box]
A-2		[Dark Brown Box]
SU	OTHER	[Diagonal Lines Box]
Incorporated		[Red-White Diagonal Lines Box]
Forest Preserve		[Green Box]

SECTION 27
RUTLAND TOWNSHIP

Revisions

Based on map of January 20, 2007.
Forest Preserve property as of January 20, 2007.

North
↑
RU-27 ZONING