

ZONING MAPS
of
KANE COUNTY, ILLINOIS
MAP NO. VI-03
MAP SCALE
0 100 200 300 400 500
FEET

Kane County, Illinois
Building and Zoning Division

Mark D. Vankerkhoff, AIA
Zoning Enforcing Officer

Kane County
Government Center
719 S. Batavia Ave.
Bldg. A, 4th Floor
Geneva, IL 60134

Phone: 630.232.3492

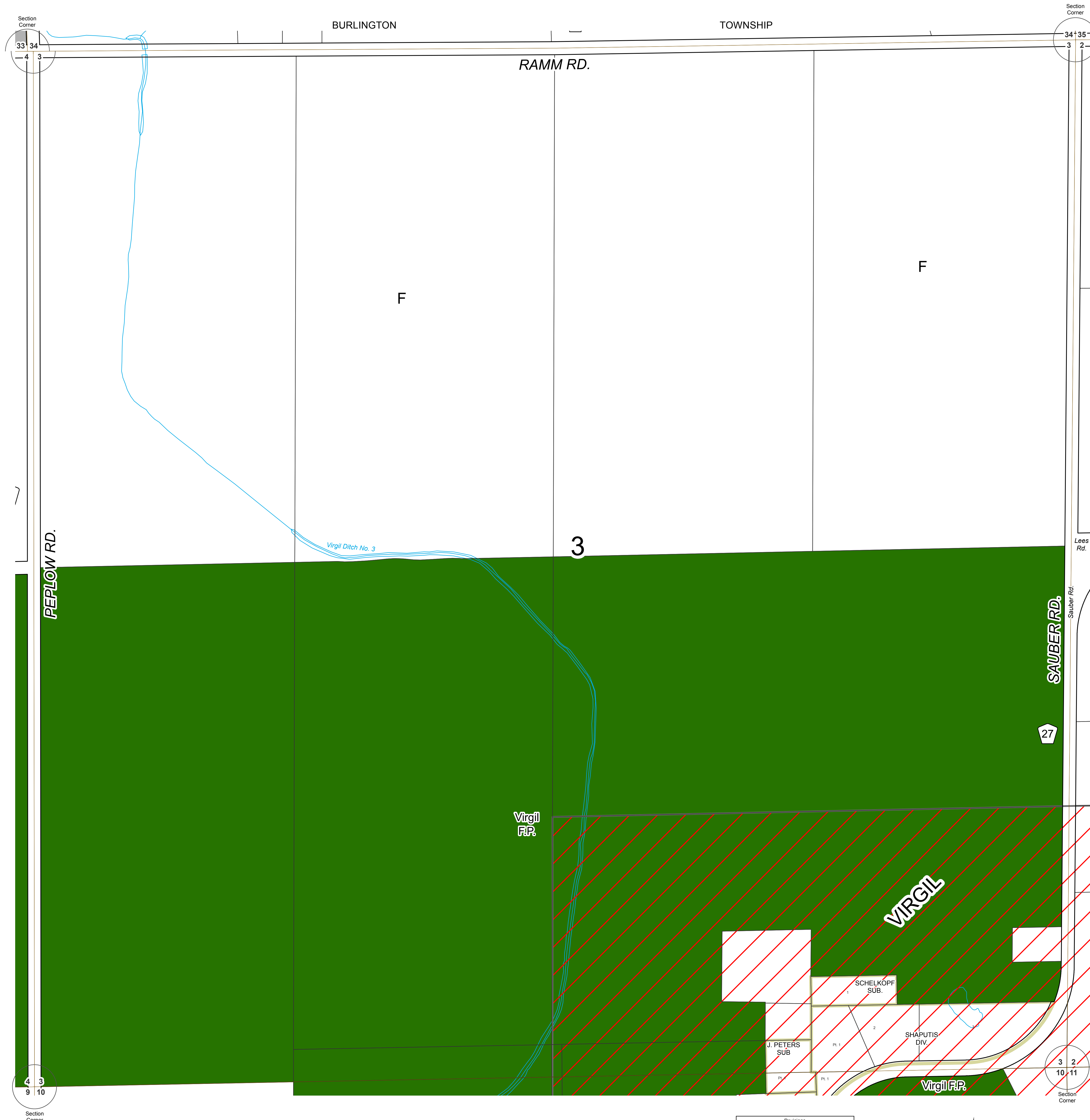

ZONING LEGEND		
FARMING DISTRICT	F	[White Box]
	F-1	[Grey Box]
	F-2	[Hatched Box]
RESIDENTIAL DISTRICT	E-1	[Light Green Box]
	E-2	[Medium Green Box]
	E-2A	[Yellow-Green Box]
	E-3	[Green Box]
	R-1	[Yellow Box]
	R-2	[Light Orange Box]
	R-3	[Orange Box]
	R-4	[Dark Orange Box]
	R-5	[Red Box]
R-6		
R-7		
R-8		
R-9	[Brown Box]	
BUSINESS DISTRICT	RB	[Light Blue Box]
	B-1	[Light Blue Box]
	B-2	[Light Blue Box]
	B-3	[Teal Box]
	B-4	[Blue Box]
	B-5	[Dark Blue Box]
SPECIAL INDUSTRIAL DISTRICT	LI	[Pink Box]
	I	[Purple Box]
SPECIAL DISTRICT	PUD	[Brown Box]
AIRPORT DISTRICT	A-1	[Light Green Box]
	A-2	[Light Green Box]
OTHER	SU	[Hatched Box]
	Incorporated	[Hatched Box]
	Forest Preserve	[Green Box]

SECTION 3
VIRGIL TOWNSHIP

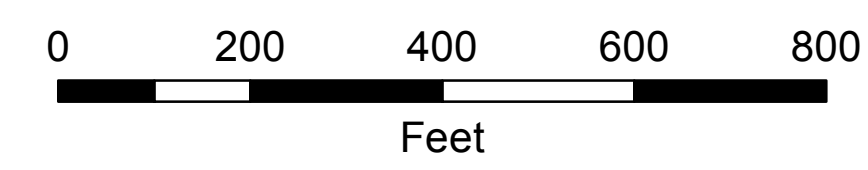

Revisions	

Digital Zoning Maps created September 9, 2003 (TMV, TJM)

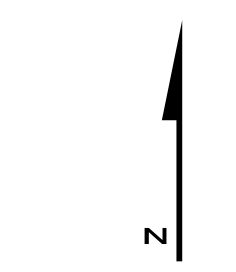

VI-03 ZONING

Base data current as of November 30, 2018.